

DISTRICT COURT, WELD COUNTY, COLORADO		DATE FILED: July 13, 2017 CASE NUMBER: 2008CV243
Court Address: 915 10 <sup>th</sup> Street Greeley, CO 80631 Telephone: (970) 475-2400		▲ COURT USE ONLY ▲
<b>Petitioner:</b> MINER'S VILLAGE METROPOLITAN DISTRICT NO. 1		
<b>By the Court:</b>		Case Number: 2008CV243 Division: 4 Courtroom:
<b>ORDER GRANTING MOTION TO CHANGE NAME OF MINER'S VILLAGE METROPOLITAN DISTRICT NO. 1 TO SILVERSTONE METROPOLITAN DISTRICT NO. 1</b>		

THIS MATTER comes before the Court on a Motion filed by Miner's Village Metropolitan District No. 1 for an Order changing the name of Miner's Village Metropolitan District No. 1 to SilverStone Metropolitan District No. 1. This Court, being fully advised in the premises and there being no objection filed by any person, hereby ORDERS:

That the name of Miner's Village Metropolitan District No. 1, which encompasses the property described in the attached Exhibit A, incorporated herein by reference, is hereby changed to SilverStone Metropolitan District No. 1, effective as of the date of this Order.

SO ORDERED this 10<sup>th</sup> day of July, 2017.

BY THE COURT:

  
DISTRICT COURT JUDGE

Certified to be a full, true and correct  
copy of the original in my custody.

Dated 07/13/2017

Rachael Erickson  
Clerk of the District Court  
Weld County, Colorado

  
Deputy



**EXHIBIT A**

**LEGAL DESCRIPTION OF THE PROPERTY CONCERNED**

# EXHIBIT

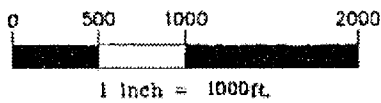
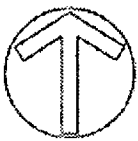
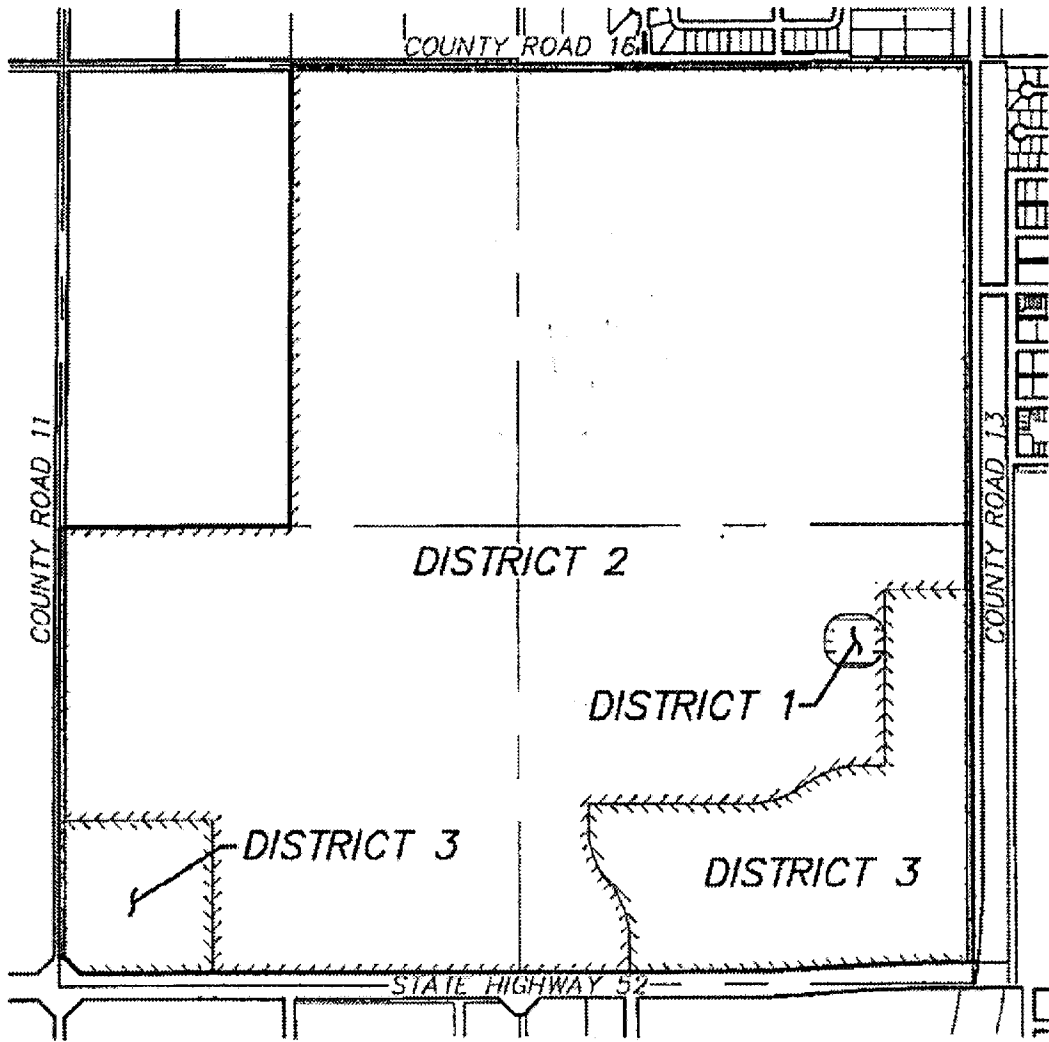

**MINER'S VILLAGE  
DISTRICT MAP  
FREDERICK, COLORADO**

SCALE HOR. 1"=1000'  
VERT. N/A  
DESIGN/APP. BD  
DRAWN BY BD  
DATE 10/30/07



**HURST & ASSOCIATES, INC**  
CONSULTING ENGINEERS  
4909 Fred Road Circle, Suite 100  
Boulder, Colorado 80501 (303) 443-4135

## EXHIBIT

### DISTRICT 1 DESCRIPTION:

A PARCEL OF LAND LOCATED IN THE SOUTHEAST QUARTER OF SECTION 35, TOWNSHIP 2 NORTH, RANGE 68 WEST OF THE 6TH P.M., TOWN OF FREDERICK, COUNTY OF WELD, STATE OF COLORADO DESCRIBED AS FOLLOWS:

COMMENCING AT THE EAST QUARTER CORNER OF SAID SECTION 36 FROM WHENCE THE NORTHEAST CORNER LIES  $N00^{\circ}07'13''W$ , 2,656.26 FEET (BASIS OF BEARINGS);

THENCE  $S37^{\circ}24'31''W$ , 824.03 FEET TO THE POINT OF BEGINNING;

THENCE  $S00^{\circ}00'00''E$ , 50.00 FEET;

THENCE 196.35 FEET ALONG THE ARC OF A TANGENT CURVE TO THE RIGHT, SAID ARC SUBTENDED BY A RADIUS OF 125.00 FEET, A CENTRAL ANGLE OF  $90^{\circ}00'00''$ , AND A CHORD BEARING  $S45^{\circ}00'00''W$ , 176.78 FEET;

THENCE  $S90^{\circ}00'00''W$ , 100.00 FEET;

THENCE 196.35 FEET ALONG THE ARC OF A TANGENT CURVE TO THE RIGHT, SAID ARC SUBTENDED BY A RADIUS OF 125.00 FEET, A CENTRAL ANGLE OF  $90^{\circ}00'00''$ , AND A CHORD BEARING  $N45^{\circ}00'00''W$ , 176.78 FEET;

THENCE  $N00^{\circ}00'00''E$ , 50.00 FEET;

THENCE 196.35 FEET ALONG THE ARC OF A TANGENT CURVE TO THE RIGHT, SAID ARC SUBTENDED BY A RADIUS OF 125.00 FEET, A CENTRAL ANGLE OF  $90^{\circ}00'00''$ , AND A CHORD BEARING  $N45^{\circ}00'00''E$ , 176.78 FEET;

THENCE  $N90^{\circ}00'00''E$ , 100.00 FEET;

THENCE 196.35 FEET ALONG THE ARC OF A TANGENT CURVE TO THE RIGHT, SAID ARC SUBTENDED BY A RADIUS OF 125.00 FEET, A CENTRAL ANGLE OF  $90^{\circ}00'00''$ , AND A CHORD BEARING  $S45^{\circ}00'00''E$ , 176.78 FEET TO THE POINT OF BEGINNING, CONTAINING 2.10 ACRES, MORE OR LESS.

**MINER'S VILLAGE  
DISTRICT NUMBER 1  
FREDERICK, COLORADO**

SCALE H&A N/A  
W&A N/A

DESIGN/APPR. BC

DRAWN BY BC

DATE 10/20/07



**HURST & ASSOCIATES, INC.**

CONSULTING ENGINEERS

4240 Pearl East Circle, Suite 100  
Boulder, Colorado 80504 (303) 440-1100

FILE D:\202007\SURVEY\LEGAL\047-DISTRICTS SHEET 1 OF 1